

1309C Disc/Cone Clutch

(02/01/2026)
DISCONTINUED
PRODUCT STYLE OR
SIZE. PARTS SHEET
IS FOR REPAIR
INSTRUCTIONS ONLY.

Parts listing is for
reference only. All
parts listed are
limited to stock
on hand. Contact
Tolomatic regarding
availability.

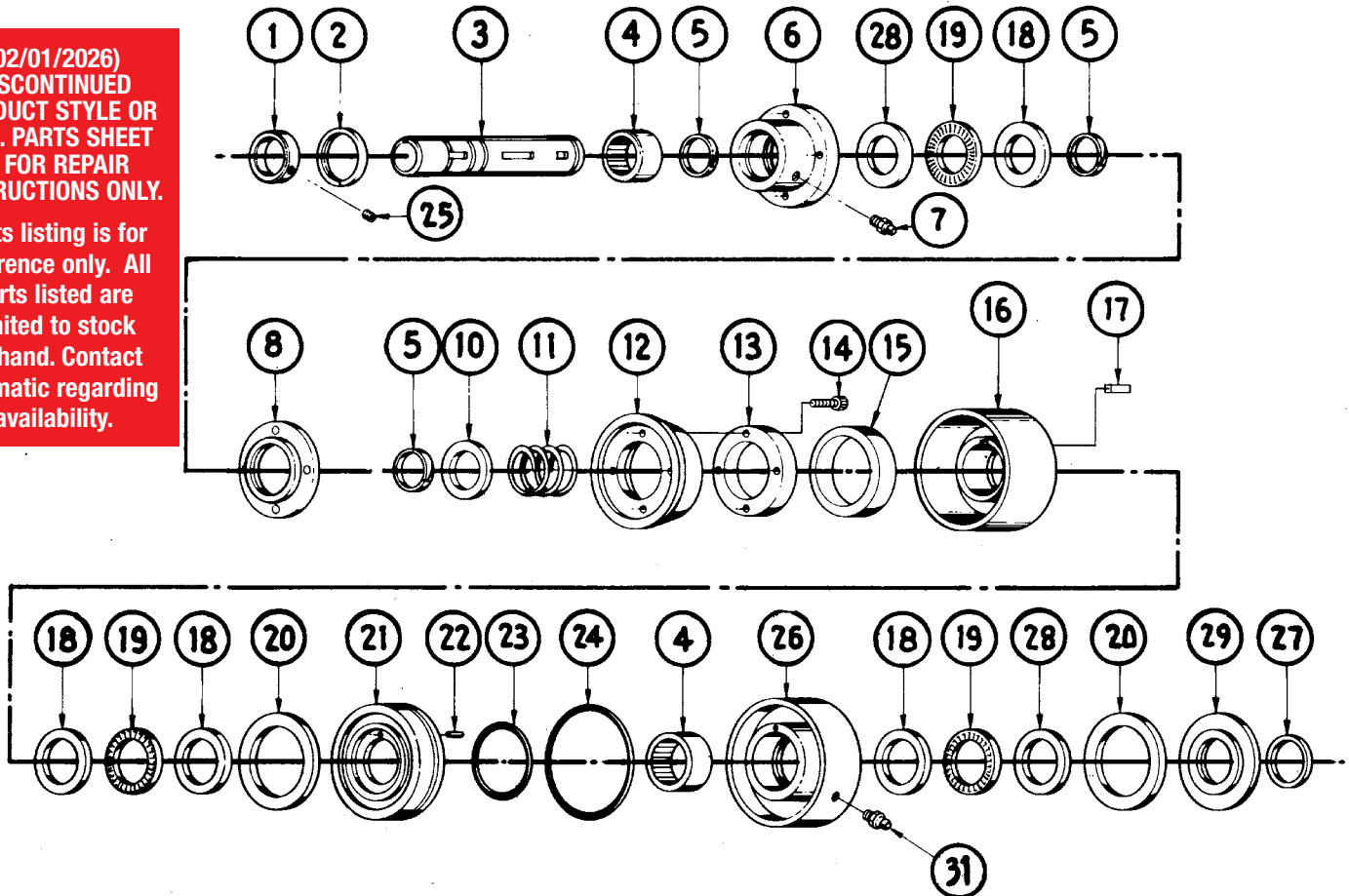

Parts Listing

ITEM	PART NO.	DESCRIPTION	Quantity			
			1309-0316	1309-0318	1309-0320	1309-0322
1	1209-1013	Collar				1
2	1209-1016	Retaining Ring	1	1	1	1
3	1209-1024	Shaft, 1" Bore	1			
	1209-1022	Shaft, 1 1/8" Bore		1		
	1209-1020	Shaft, 1 1/4" Bore			1	
	1209-1000	Shaft, 1 3/8" Bore				1
4	1309-1017	Needle Bearing	2	2	2	2
5	1309-1011	Retaining Ring	2	2	2	2
6	1209-1018	Adapter	1	1	1	1
7	0100-1601	Fitting, Grease	1	1	1	1
8	1209-1002	Cone, Adapter	1	1	1	1
10	1209-1008	Spring Back-Up Washer	1	1	1	1
11	1209-1009	Return Spring	1	1	1	1
12	1209-1003	Cone	1	1	1	1
13	1309-2007	Adapter	1	1	1	1
14	1209-1019	Soc. Hd. Cap Screw	4	4	4	4
15	1309-2003	Felt Retainer	1	1	1	1
16	1309-2028	Cup	1	1	1	1

ITEM	PART NO.	DESCRIPTION	Quantity			
			1309-0316	1309-0318	1309-0320	1309-0322
17	1309-1010	Key	1	1	1	1
18	1309-1020	Thrust Race	4	4	4	4
19	1309-1018	Thrust Bearing	3	3	3	3
20	1209-1010	Felt Seal	2	2	2	2
21	1209-1005	Piston	1	1	1	1
22	1209-1017	Spring Pin	1	1	1	1
23	1209-1015	O-Ring	1	1	1	1
24	1029-1033	O-Ring	1	1	1	1
25	1308-1013	Set Screw				2
	1303-1174	Set Screw	2	2	2	
26	1209-1006	Cylinder	1	1	1	1
27	1209-1060	Retaining Ring	1	1	1	1
28	1309-2019	Thrust Race	2	2	2	2
29	1209-1007	Felt Seal Adapter	1	1	1	1
31	1208-1034	Fitting, Grease	1	1	1	1

INSTALLATION

The Tolomatic Disc/Cone Clutch is as simple to install as a sprocket or sheave.

Simply slip the clutch over the shaft to the desired position, align with keyway and insert key (#17). After final alignment with mating sprocket or sheave, tighten set screws (#25) to lock clutch in place.

Connect air or hydraulic source not exceeding 100 psi (7 bars) pressure to cylinder port. Make sure no side or end thrust is transmitted to clutch. Flexible hose (not plastic tubing) may be used. A restraining member may be necessary to prevent cylinder rotation.

Lubrication will be required after every four (4) weeks of operation. Use a lubricant such as Mobilith® SHC 460 or equivalent. Two zerk fittings are provided for this purpose.

After long periods of operation, it may be necessary to disassemble the clutch for cleaning and inspection.

⚠ CAUTION! CLUTCHES ARE UNDER SPRING TENSION. USE CARE WHEN DISASSEMBLING.

MAINTENANCE

To disassemble, remove the retaining ring (#27) from the cylinder end of the clutch shaft and slide all parts off this end. Assemble all parts onto the shaft from the opposite end. This procedure is necessary to keep from damaging the edges of the bearing seal lips. See exploded view on the other side for proper sequence of assembly.

Wipe off all of the old lubricant before applying fresh grease. Use Mobilith® SHC 460 or equivalent. If it is necessary to remove the piston from the cylinder, re-lubricate the O-rings with a mineral-based O-ring grease.

Remove any grease that may have contacted the cone and clean out any foreign material in the cup. Be careful not to re-contaminate any internal parts.

Mobilith® SHC 460 is a registered trademark of Exxon Mobil Corporation, www.mobil.com

**(02/01/2026) DISCONTINUED PRODUCT
STYLE OR SIZE. PARTS SHEET IS FOR
REPAIR INSTRUCTIONS ONLY.**

**Parts listing is for reference only. All
parts listed are limited to stock on hand.
Contact Tolomatic regarding availability.**

TolomaticTM
EXCELLENCE IN MOTION

3800 County Road 116, Hamel, MN 55340 USA
<http://www.Tolomatic.com> • Email: Help@Tolomatic.com
Phone: (763) 478-8000 • Toll Free: 1-800-328-2174

COMPANY WITH
QUALITY SYSTEM
CERTIFIED BY DNV
= ISO 9001 =

All brand and product names are trademarks or registered trademarks of their respective owners. Information in this document is believed accurate at time of printing. However, Tolomatic assumes no responsibility for its use or for any errors that may appear in this document. Tolomatic reserves the right to change the design or operation of the equipment described herein and any associated motion products without notice. Information in this document is subject to change without notice.